

How do I add Nameservers to my domain?

- 2023-01-03 - Διαχείριση domains

If you want to add the Nameservers of your hosting plan to your domain at Papaki, follow these simple steps below:

1) [Log into](#) your Control Panel and click on the domain you wish.

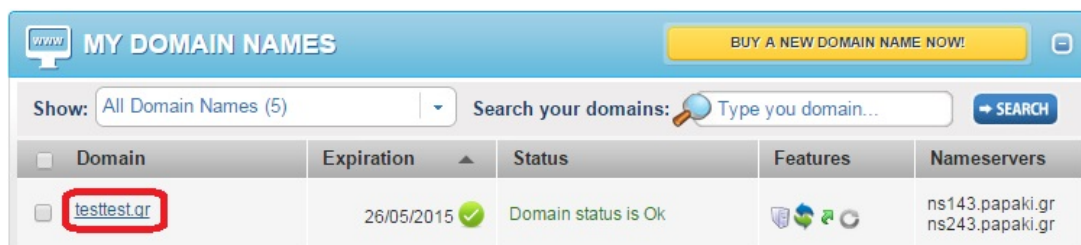

2) Click on the icon "Nameservers" and insert the Nameservers that you will find in the email with your hosting credentials.

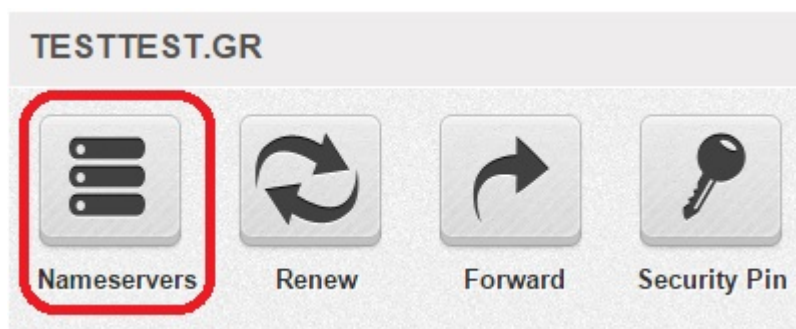

3) In the first field insert the primary Nameserver and in the second field the secondary Nameserver. Then, click **Continue**.

Manage Nameservers (testtest.gr)

testtest.gr[Manage DNSSEC \(DS Records\)](#)

- Please insert the nameservers of your option to the selected domain names.
- If you wish to create your own nameservers, insert them at the following fields and click 'Continue'. At the next page you will be asked to insert the nameservers IPs
- If you want to delete nameservers, just delete their address and click continue.

1.

 or

[Select from the existing Nameserves]

2.

 or

[Select from the existing Nameserves]

3.

 or

[Select from the existing Nameserves]

4.

 or

[Select from the existing Nameserves]

 [Add](#)

Continue

4) Check again that you have inserted the right nameservers and finally, click on Update **Nameservers**. You are all set!

Manage Nameservers (testtest.gr)

testtest.gr[Manage DNSSEC \(DS Records\)](#)

- This Action it maybe inactivate your domains, if you are sure press "Update Nameservers" or otherwise close this window.
- Update has not been completed. Click on the "Update Nameservers" in order to complete the procedure

Before the Update
ns143.papaki.gr (185.4.134.210)
ns243.papaki.gr (185.4.134.211)

After the Update
ns143.papaki.gr (185.4.134.210)
ns243.papaki.gr (185.4.134.211)

Return

Update Nameservers

Tip: Always remember that you need to wait for 4-48 hours from the moment you insert the nameservers, in order for your ISP to update its records. This period depends solely on the provider and not Papaki.